





Research Article

The Phoenician diaspora in the westernmost Mediterranean: recent discoveries

José Suárez-Padilla¹ , Víctor Jiménez-Jáimez^{1,*}  & José L. Caro² 

¹ Departamento de Ciencias Históricas, Universidad de Málaga, Spain

² Departamento de Lenguajes y Ciencias de la Computación, Universidad de Málaga, Spain

* Author for correspondence: ✉ vjj Jaimez@uma.es

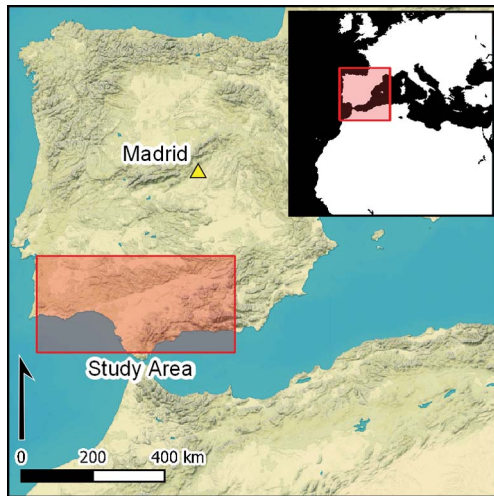

Important discoveries over the past 15 years in the coastal area between Huelva and Málaga in Spain have illuminated the beginnings of the eighth-century BC Phoenician diaspora into the Western Mediterranean. Here, the authors combine Bayesian modelling of recently published radiocarbon dates with the latest archaeological data to investigate the Phoenician presence in southern Iberia. Their assessment of its significance for the Late Bronze and Early Iron Ages in the Western Mediterranean contributes not only to understanding the integration of the Phoenicians into local communities, but also to apprehending the mechanisms of colonisation and pre-colonial situations elsewhere in protohistoric Europe and other world contexts.

Keywords: Mediterranean, Spain, Bronze Age, Iron Age, Phoenicians, colonialism

Introduction

In the early first millennium BC, the Late Bronze Age communities of southern Iberia occupied hilltop settlements that were often fortified. Their houses were sometimes large, frequently oval in plan and made from perishable materials; some had stone foundations. These communities were probably not organised along state-based lines; instead kinship played a significant role in these societies (e.g. González Wagner 2000), although there is some evidence of ranking, illustrated, for example, by the so-called ‘warrior stelae’ (García Alfonso 2007: 385; Berrocal-Rangel & Silva 2010: 429). These communities produced hand-made ceramics and metal objects, mostly of bronze, being well located to exploit the rich copper sources of the Iberian Pyrite Belt and to participate in the Atlantic tin and gold exchange networks (Iacono *et al.* 2021). Moreover, southern Iberia was connected to

Received: 16 May 2020; Revised: 3 October 2020; Accepted: 8 October 2020

© The Author(s), 2021. Published by Cambridge University Press on behalf of Antiquity Publications Ltd. This is an Open Access article, distributed under the terms of the Creative Commons Attribution licence (<https://creativecommons.org/licenses/by/4.0/>), which permits unrestricted re-use, distribution, and reproduction in any medium, provided the original work is properly cited.

the contemporaneous Mediterranean trade routes. Seafarers from elsewhere in the Mediterranean frequented the area, trading and perhaps even living temporarily amongst the local populations (for a full discussion, see Ruiz-Gálvez Priego 2013: 278–86), while life went on as usual for the vast majority of Late Bronze Age southern Iberian communities.

In the ninth century BC, Phoenicians from Tyre in the Levant began to settle in the region. By the eighth century BC, they had created a number of ‘colonies’, most notably Gadir in modern Cádiz. Yet the term colony covers a range of situations, not necessarily simply a straightforward implantation of external populations. The Phoenicians were not in a position to simply impose their will on the local southern Iberian communities; the latter were not passive in this process (Delgado Hervás 2008: 377–79) and their consent and support were necessary. The establishment of mutually beneficial relations that culminated in the founding of Phoenician ‘colonies’ in Iberia required time and negotiation, a theme to which we return in our closing discussion. Some transitional stage, characterised by increasing interactions between Indigenous groups and Phoenician newcomers, must have existed before the emergence of Gadir. But what was the nature of such relations? For decades archaeological narratives of this transitional period suffered from a lack of data, but over the past 15 years, important discoveries, especially in the coastal area between Huelva and Málaga (Spain), have illuminated the beginnings of the Phoenician diaspora in the Western Mediterranean, before formal colonies came into being. Here, we synthesise the latest data and assess their significance for understanding the Late Bronze Age and Early Iron Age in the westernmost Mediterranean.

It is worth noting at the outset that the chronology of this period, both traditional and current, relies primarily on cross-dating methods based on typological links between Phoenician and Greek ceramic wares found in the Western Mediterranean, and other, more securely dated, wares found in the Eastern Mediterranean. Until recently, relevant radiocarbon dates were few, and they appeared not to match historical chronologies or typological cross-dating. As a new contribution to this issue, this article includes a statistical analysis of a series of radiocarbon dates from Huelva.

New evidence from the earliest Phoenician settlements in Iberia

Huelva (Spain)

The hinterland of present-day Huelva, located to the west of the Strait of Gibraltar (Figure 1), is rich in mineral and metal resources. Research conducted in the estuary formed by the confluence of the Tinto and Odiel Rivers has yielded data on what might be the earliest evidence for the continued presence of Phoenicians in southern Iberia (González de Canales 2018). In the early first millennium BC, this Atlantic coastal area was characterised by alternating promontories and natural inlets. Some of these hills (*cabezos*) were frequented by local communities from at least the Late Bronze Age (Gómez Toscano *et al.* 2014: 141), although little is known about their settlements.

In the ninth century BC, a settlement was established on the Cabezo de San Pedro (phase 1) in what is now the city of Huelva, itself on a peninsula within the estuary. While this is widely considered to be an Indigenous centre, it nonetheless exhibits clear

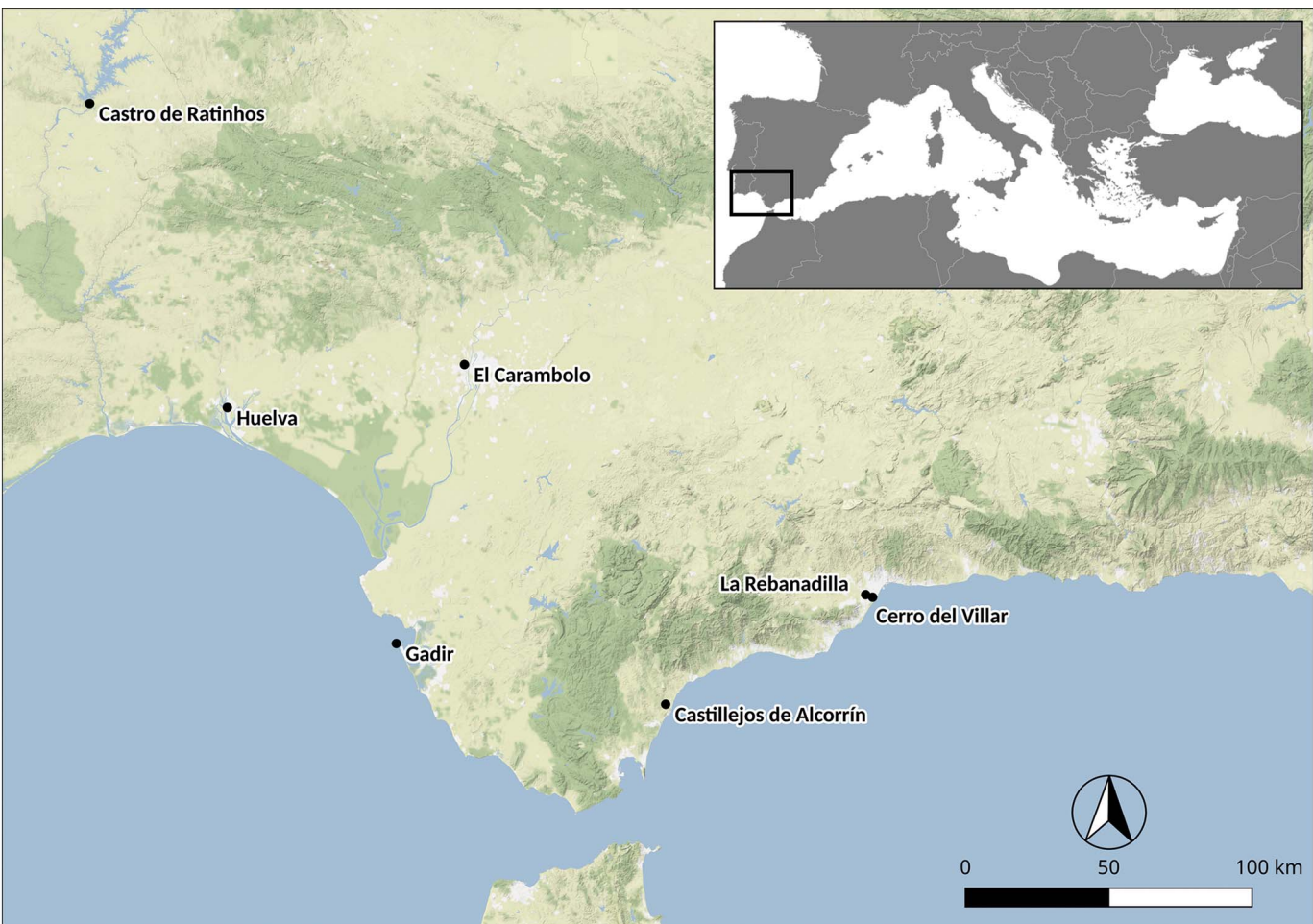

Figure 1. Location of the sites mentioned in the text (map tiles by Stamen Design, under CC BY 3.0.; data by OpenStreetMap, under OdbL).

evidence of contact with the Phoenicians: in its upper part, a wall was constructed using techniques that are consistent with Levantine traditions (González de Canales *et al.* 2018). Moreover, excavations at the sites of Plaza de las Monjas 12, Calle Méndez Núñez 7–13 (González de Canales *et al.* 2004) and Calle Concepción 3 (García Fernández *et al.* 2016) have located the lower parts of the settlement, which probably included a port, at the foot of the Cabezo de San Pedro. Thick layers on these sites, perhaps representing rubbish middens, have yielded rich assemblages of finds. These include locally made pottery similar in proportion to that from San Pedro phase 1, together with eastern Phoenician ceramics, and, to a lesser extent, fragments of wares of Cypriot, Sardinian, Attic Greek (Middle Geometric II, c. 850–800 BC; García Alfonso 2016), Euboean-Cycladic and Villanovan origin. The presence of foreign craftspeople in the area is suggested by the earliest-known evidence of iron and silver metalworking in Iberia (Murillo-Barroso *et al.* 2016) and Phoenician graffiti on ceramics. A set of lead weights based on the Phoenician *shekel* (a metric system) (González de Canales *et al.* 2004: pl. LXIV & 21–24) indicates trade activities (Aubert 2012: 232). Common grape (*Vitis vinifera*) seeds have been recorded on these three sites (Pérez-Jordà *et al.* 2017), and cultivation trenches suggestive of viticulture have been identified 3km to the north-east at the site of La Orden-Seminario (González de Canales *et al.* 2020).

Castro de Ratinhos (Moura, Portugal)

Castro de Ratinhos (Berrocal-Rangel & Silva 2010; Berrocal-Rangel *et al.* 2012) is an Indigenous Late Bronze Age fortified settlement located on a promontory overlooking a natural ford of the River Guadiana (Figure 1). Excavations here have revealed an acropolis enclosed by an inner wall and a small outer ditch. The earliest houses were large and oval, with narrow bases made of stone slabs that were embedded vertically in the ground (phase 2, thirteenth to ninth centuries BC). In this part of the settlement, these houses were scattered, with no apparent spatial order, and succeeded one another in four superimposed levels.

During phase 1b (ninth century BC), the internal spatial organisation of the site remained fundamentally unchanged, although certain foreign practices were adopted. In the upper part of the settlement, new, large houses were built over the remains of the earlier ones. These new houses had perfectly circular plans, with a radius in keeping with ‘Ezekiel’s cubit’ (0.52m), a measurement unit almost certainly introduced by the Phoenicians. Their stone foundations were also built using non-local techniques. Additionally, a ‘special’ building (MN23) was erected at this time (Figure 2A). Its L-shaped ground plan, comprising multiple cells, mimics Levantine models. Liturgical paraphernalia, such as a *baetylus* (a sacred stone), were found inside (Berrocal-Rangel & Silva 2010: 188–92). Of particular note are seven carefully buried, small, gold buttons typical of the Atlantic Late Bronze Age, but Eastern Mediterranean techniques, such as filigree, were employed in their manufacture (Berrocal-Rangel & Silva 2010: 325). The building has been interpreted as a small temple dedicated to Baal and Asherah (Prados Martínez 2010). Even in these times of change, most local craft traditions, such as hand-made pottery and bronze metallurgy, continued.

Sometime around the mid-eighth century BC the buildings and the enclosing wall were destroyed or repurposed. New houses of Indigenous style and construction technique, reminiscent of those from phase 2 of the settlement, were built in their place (phase 1a).

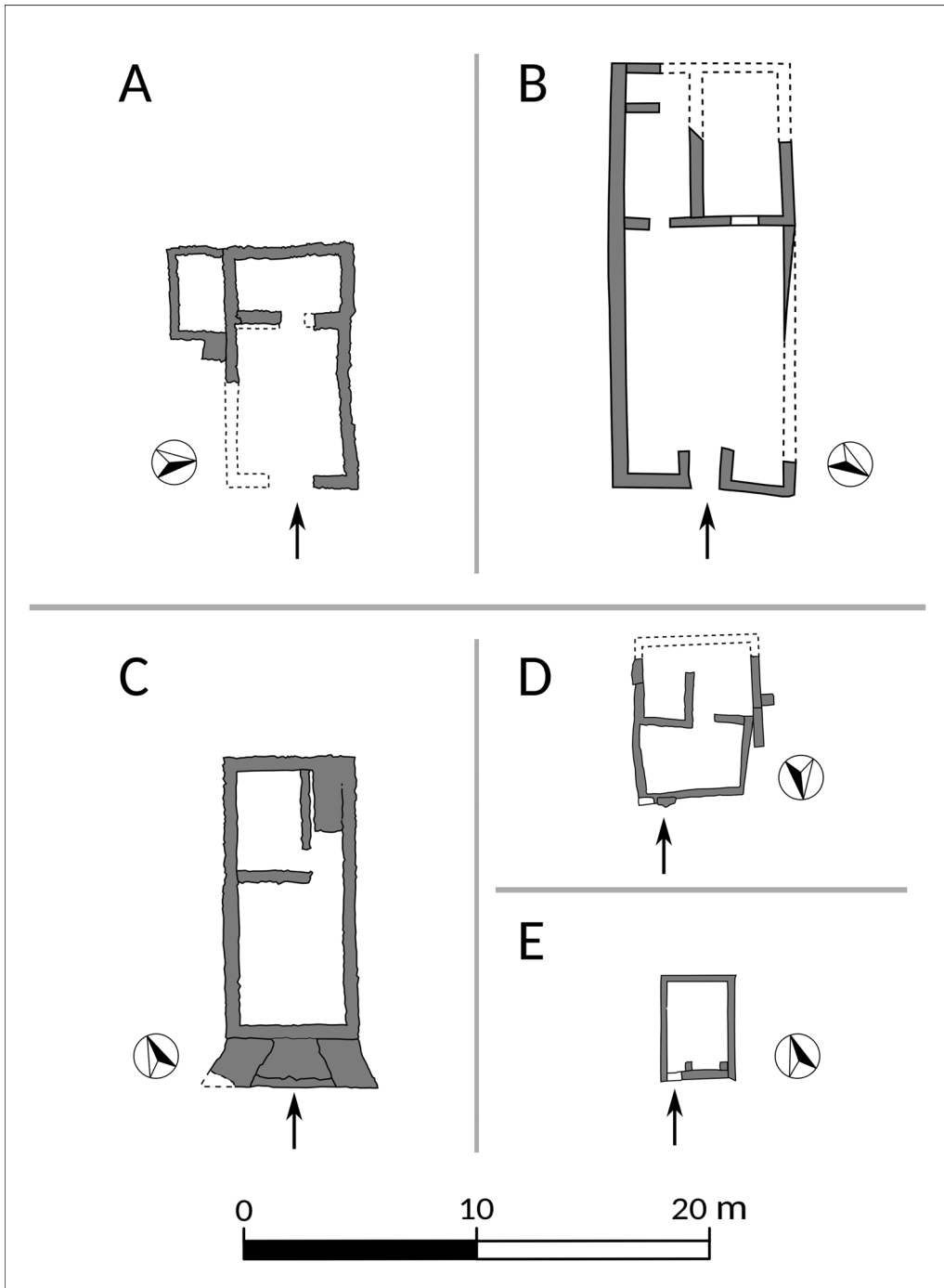

Figure 2. Floor plans of Early Iron Age A rectangular buildings: A) Castro de Ratinhos MN23 (Moura, Portugal) (modified from Berrocal-Rangel et al. 2012: fig. 4.1); B) El Carambolo V (Seville, Spain) (modified from Fernández Flores & Rodríguez Azogue 2005: fig. 2); C) Castillejos de Alcorrín Building A (Manilva, Málaga, Spain) (modified from Marzoli et al. 2010: fig. 6); D–E) La Rebanadilla temple 2 and temple 1 (Málaga, Spain) (modified from Sánchez Sánchez-Moreno et al. 2018: figs 3–4).

El Carambolo (Camas, Seville, Spain)

At the beginning of the first millennium BC the mouth of the River Guadalquivir formed a wide, navigable estuary that extended inland for tens of kilometres. There, the site of El Carambolo occupies a promontory near the modern city of Seville, close to natural paths that led to the rich mining region of Aznalcóllar (Figure 1; Fernández Flores & Rodríguez Azogue 2005, 2010; Escacena Carrasco *et al.* 2007).

In the Late Bronze Age several pits at the site were dug and perhaps ritually backfilled; locally produced, handmade wares dominated their assemblages. Radiocarbon-dating suggests that this activity took place sometime between the fourteenth and the twelfth centuries BC. Later, in the late ninth and early eighth centuries BC (based on ceramic typology), a mud-brick building was erected on the upper part of the hill (Figure 2B). This building is interpreted as a Phoenician temple or sanctuary (Fernández Flores *et al.* 2020), perhaps dedicated to Astarte, as suggested by the nearby presence of a bronze statuette of Astarte with a Phoenician inscription on its base, and the existence of seashell floors. Such floors are often considered indicative of Phoenician influence, as they first appeared in coastal areas of the Levant in the second millennium BC. In the Eastern Mediterranean their presence is commonly associated with cultic contexts, as they appear to have had an apotropaic character. This has informed the interpretation of analogous phenomena in the Western Mediterranean (Escacena Carrasco & Vázquez Boza 2009). Originally (Carambolo phase V), and in typical Levantine fashion, the building's floor plan was rectangular, with a courtyard surrounded by a continuous bench, and two rear cellars. An altar was erected inside one of these spaces. Associated ceramics and other materials are overwhelmingly local in origin.

Castillejos de Alcorrín (Spain)

Although much remains unknown about the Late Bronze Age in the Guadiaro region to the east of the Strait of Gibraltar (Figure 1), we do know that it was populated in the Late Bronze Age, and that foreign artefacts reached the area in the early first millennium BC (Marzoli *et al.* 2014). Various points along the coast must have provided convenient stopping places for ships on their way to the Atlantic Ocean.

In the late ninth century BC a massive fortified settlement was built at Los Castillejos de Alcorrín (Manilva, Málaga), approximately 7km from the mouth of the Guadiaro River (Marzoli *et al.* 2010, 2020a). The external rampart is more than 2km long and encloses an area of 11.3ha. The wall was reinforced with semi-circular towers at its weakest points. In addition, recent geophysical surveys and excavations have revealed an internal rampart comprising an outer ditch and an inner wall, which delimit an 'acropolis'. Various scattered buildings have been found within, including a large ellipsoidal structure constructed in the local Late Bronze Age style (building C). By contrast, other buildings have a clear Levantine-influenced appearance. Building A, for example, is a rectangular structure with a trapezoidal porch paved with seashells, as well as a courtyard and two rear rooms (Figure 2C). Excavation of building A yielded almost no finds. Evidence of iron working involving ores extracted from nearby mines was recovered at Alcorrín (Marzoli *et al.* 2014; Renzi *et al.* 2016). In the eighth century BC the rectangular buildings were enlarged and remodelled

(phase 2). Their assemblages, particularly the ceramics, continued to be predominantly local, with rare fragments of western Phoenician wares. Alcorrín was finally abandoned towards the end of the eighth century BC (Marzoli *et al.* 2020b).

The bay of Málaga

The bay of Málaga lies some 100km east of the Strait of Gibraltar. Two major ancient watercourses flowed into the sea here: the Guadalhorce, which formed a wide estuary that is now almost completely silted up, and the Guadalmedina, around which the modern city of Málaga is situated.

Although Late Bronze Age settlements are not well known in this area, a Phoenician presence is visible from the second half of the ninth century BC onwards. Excavations at the site of La Rebanadilla (Sánchez Sánchez-Moreno *et al.* 2011, 2012, 2018) on an islet in the Guadalhorce estuary have revealed a series of scattered pits containing the remains of metalworking and Indigenous pottery (Rebanadilla phase IV). One pit contained various exotic items, including fragments of Levantine fine ware and other red-slipped pottery, and of Sardinian and Greek vases, including two Middle Geometric II *skyphoi* (García Alfonso 2016: 125). Shortly thereafter, but still within the second half of the ninth century BC, La Rebanadilla witnessed considerable changes (phase III), including the construction of a rammed-earth enclosure delimiting an area of around 2ha. This space enclosed a series of rectangular buildings separated by streets. Outstanding amongst these is building 5 (or temple 2; Figure 2D), a rectangular structure within which various ritual items have been found, such as a baetylus and a red-slipped *thymiaterion* (incense burner). Building 4 (or temple 1) consists of a single large room with an altar (Figure 2E). La Rebanadilla III has also yielded a series of graffiti, some of which appear votive in character, with one possibly mentioning the Phoenician god Eshmun. Hence, La Rebanadilla III is considered a ritual area (Sánchez Sánchez-Moreno *et al.* 2018).

In 770–760 BC, the Phoenicians founded Cerro del Villar, one of the largest ‘colonies’ in southern Iberia, on an island in the delta close to the mouth of the Guadalhorce (Aubert 2019: 82). Around that time the ritual area at La Rebanadilla was abandoned and superseded by newly built huts with oval plans (phase I).

Dating the establishment of the ‘Phoenician quarter’ at Huelva

The data presented above suggest that the Phoenicians first settled in southern Iberia at Huelva, although they were perhaps also present at Ratinhos (phase 1b), El Carambolo (phase V), Alcorrín (phase 1) and La Rebanadilla (phases IV–III). Archaeologists have identified the ninth century BC as the most likely date for these Phoenician settlement events, based on ceramic typologies. Some argue that this process started in the first half of the ninth century (e.g. González de Canales *et al.* 2004, 2018; Mederos Martín 2006), but most suggest the second half of the ninth century (Gilboa 2013; García Alfonso 2016; Núñez 2018; Aubert 2019). Here we present a Bayesian analysis of a series of recently published radiocarbon dates from various contexts at Huelva (Table 1). We were particularly interested in determining the start and end dates for the earliest stages of the Phoenician

Table 1. Radiocarbon dates from Huelva subject to statistical Bayesian analysis (dates calibrated with OxCal v4.3.2, using the IntCal13 atmospheric curve (Reimer *et al.* 2013; Bronk Ramsey 2017)).

Lab ID	Sample type	Identification	Date BP	Reference	Calibrated BC date		Modelled BC date					
					68.2%	95.4%	68.2%	95.4%	μ	σ	m	
Tau_Boundary Start Huelva							906–827	1007–808	886	59	872	
Beta 406165	Seed	<i>Hordeum vulgare</i>	2800±30	Pérez-Jordà <i>et al.</i> (2017: 533)	996–915	1027–848	981–901	1008–841	932	43	933	
GRN-29512	Animal bone	N/A	2775±25	Nijboer & van der Plicht (2006: 32)	975–856	996–845	936–844	976–835	903	39	906	
GRN-29511	Animal bone	N/A	2745±25	Nijboer & van der Plicht (2006: 32)	910–843	970–826	901–836	926–821	871	29	866	
GRN-29513	Animal bone	N/A	2740±25	Nijboer & van der Plicht (2006: 32)	905–842	931–822	897–834	921–820	867	28	864	
Beta 295783	Seed	<i>Vitis vinifera</i>	2640±30	Pérez-Jordà <i>et al.</i> (2017: 533)	823–797	893–786	821–797	842–787	812	15	809	
Beta 429022	Seed	<i>Hordeum vulgare</i>	2630±30	Pérez-Jordà <i>et al.</i> (2017: 533)	816–794	838–777	815–795	836–786	808	13	806	
Beta 406164	Seed	<i>Vitis vinifera</i>	2590±30	Pérez-Jordà <i>et al.</i> (2017: 533)	804–778	820–595	807–787	816–772	796	10	797	
Boundary End Huelva							801–771	811–731	779	23	785	

presence at Huelva, and comparing them with chronologies based on ceramic typologies. Although there is some discussion about the specific stratigraphic contexts from which some of these samples were taken, all are indisputably associated with ninth-century BC Mediterranean ceramics. We used OxCal v4.3.2 (Bronk Ramsey 2017) and the IntCal13 atmospheric curve (Reimer *et al.* 2013), and applied a TAU approach to mitigate the plateau affecting the older dates in our dataset.

The results, supported by an Amodel of 102.6 and an Aoveral of 102.3, are revealing (Figure 3). With a 68.2 per cent certainty, our series begins in 906–827 BC (average 886 BC, with a standard deviation of 59 years and a median in 872 BC). It ends, also with a 68.2 per cent certainty, in 801–771 BC (average 779 BC, with a standard deviation of 23 years and a median in 785 BC). We draw two conclusions from this. First, the modelled dates match the expected chronological range of the associated ceramics. Second, both lines of evidence appear to confirm that the Phoenician quarter at Huelva was established in the ninth century BC, probably in its second half.

Discussion

In the mid- to late ninth century BC, King Ithobaal of Tyre initiated an expansionist commercial policy. Ancient texts describe the deals agreed with foreign officials to establish Phoenician ‘districts’ or ‘quarters’ in non-Phoenician settlements (Aubet 2012). There, Phoenician merchants settled and traded, often paying tributes or taxes to the local authorities. Such deals were often put under the protection of divine powers, thus requiring the construction of temples. Examples of Phoenician commercial districts include Samaria in the Levant and Kommos in Crete. Soon, Phoenicians spread farther westward, probably in search of metals (Aubet 2019: 75–77).

This Phoenician diaspora marks the onset of what we call the Early Iron Age A in southern Iberia (Figure 4). At this time, Indigenous groups began to show more interest in coastal areas than previously (Aubet 2019: 80). The archaeological data presented here show a diversity of forms of interaction between local people and newcomers. Phoenician ‘quarters’, of which Huelva is the most likely example, represent one form of such interaction: Phoenician traders probably settled in the lower town at Huelva under the protection of the local authorities, while the local population occupied the Cabezo de San Pedro (Aubet 2012: 232). Sanctuaries located in a neutral or peripheral area constitute another type of evidence. Such sites probably included at least one temple and several ancillary structures for accommodation and various economic activities. They most likely functioned as marketplaces, where newcomers and local populations met. Thus, they cannot simply be considered as ritual spaces, but also as small economic centres and gathering places. La Rebanadilla and El Carambolo appear to fit this description (Delgado Hervás 2014: 284–86). The Levantine-style ‘temple’ built within an Indigenous settlement at Ratinhos MN23, and perhaps Alcorrín Building A, represent a third category.

Cultural practices combining features of both Eastern and Western traditions began to appear in the late ninth century, such as the new building techniques recorded at Ratinhos. It is difficult to know how many Phoenicians visited those places, or for how long, but Levantine artisans must have been present, working for local leaders. None of this implies

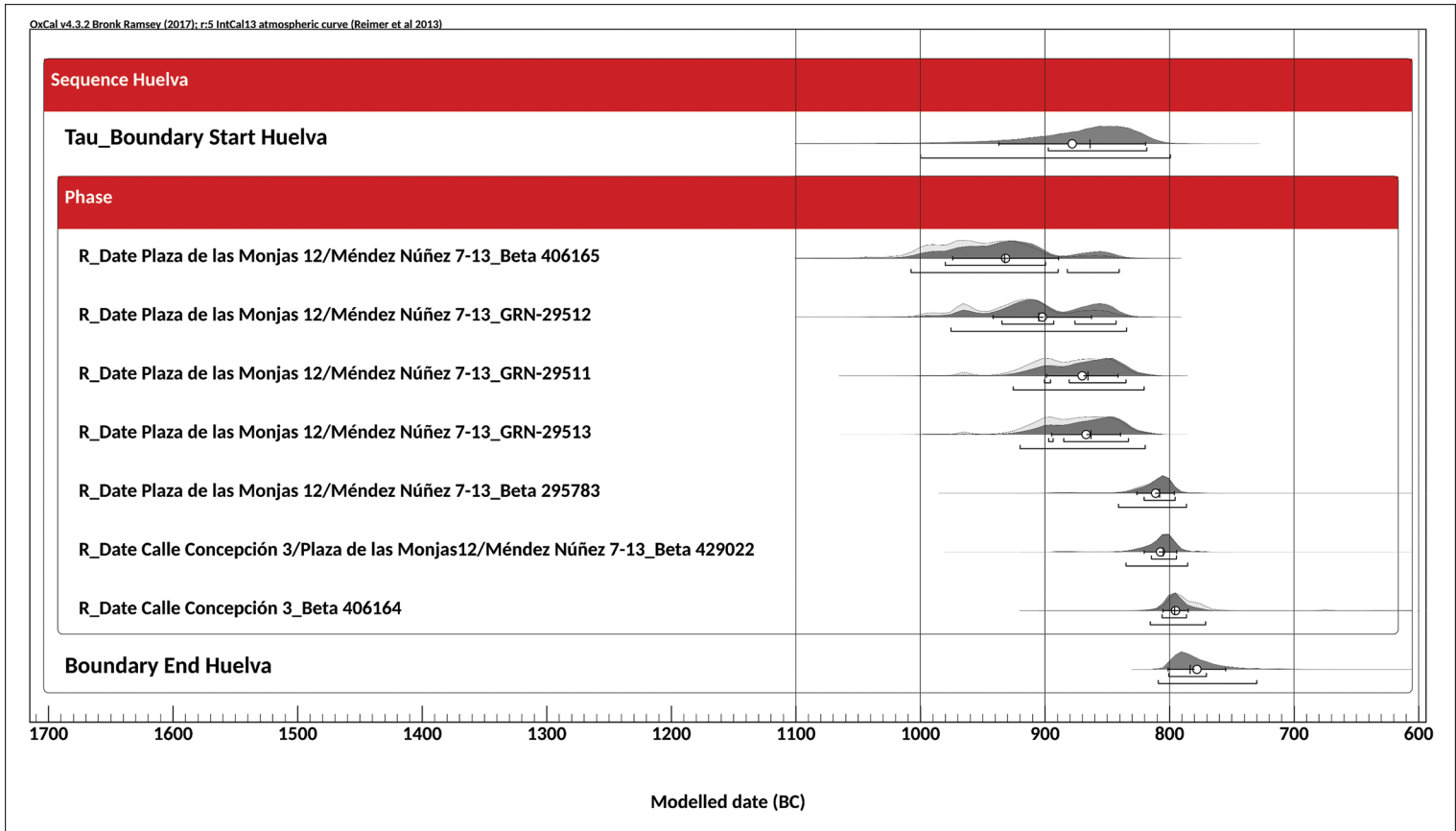

Figure 3. Bayesian analysis of the radiocarbon dates from Huelva included in Table 1 (dates calibrated with OxCal v4.3.2, using the IntCal13 atmospheric curve (Reimer et al. 2013; Bronk Ramsey 2017)) (figure by the authors).

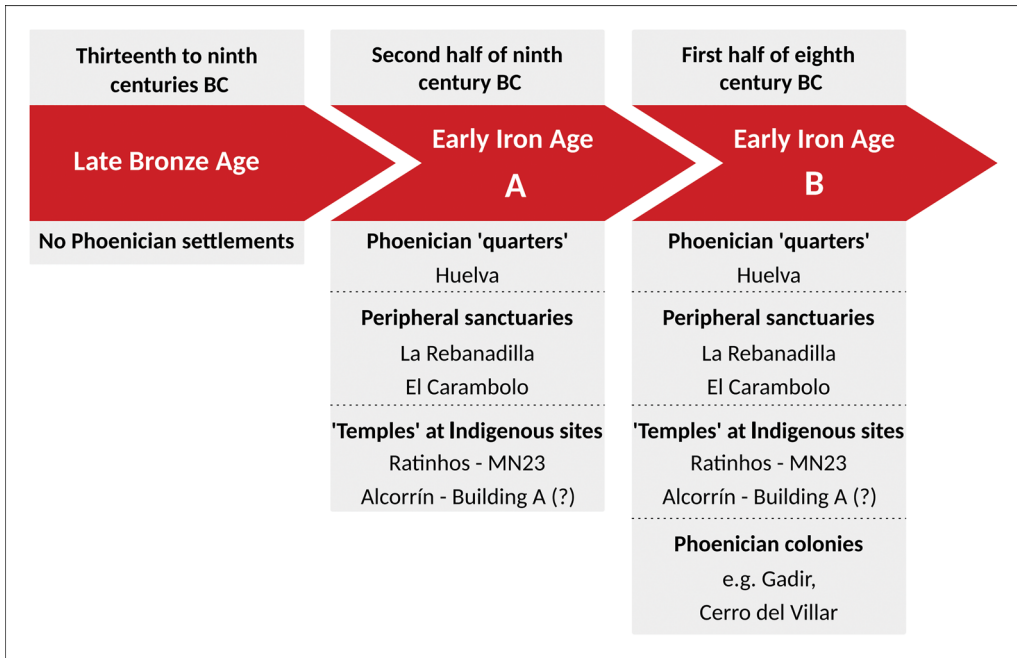

Figure 4. Diagram summarising the chronology of the earliest Phoenician presence in southern Iberia, with examples (figure by the authors).

Phoenician political control over lands or pre-existing Indigenous groups. Rather, it seems reasonable to suggest that the attitude of local populations towards the Levantine incomers was the deciding factor between the alternative approaches represented by the types of sites outlined above. For the same reasons, the speed of the process may have also varied between each local area.

The transition from the ninth to the eighth century saw important changes in settlement patterns in the region. Principal among them was the foundation of several Phoenician 'colonies'. In Iberia these 'colonies' are essentially a phenomenon dating from the eighth century BC onwards. In our view, their emergence marks the beginning of a new period, which we call the Early Iron Age B (eighth century BC) (see also López Castro 2019). There is some chronological overlap between this period and the Early Iron Age A: recent fieldwork and material typologies have shown that Gadir (present-day Cádiz), the earliest Phoenician settlement of 'colony' type in the region, was first occupied in the closing years of the ninth century (Torres Ortiz *et al.* 2014). Furthermore, some Early Iron Age A settlements and buildings persisted into the eighth century BC (see below). Yet even the earliest 'colony' at Gadir clearly post-dates the Phoenician 'quarter' at Huelva. Moreover, these colonies are conceptually very different from previous Phoenician settlements in the area.

Formal colonies usually occupied favourable coastal harbour locations, such as promontories or islets near the mouth of a river. Their establishment entailed the arrival of a considerable number of Levantine migrants, as reflected in their material culture, mortuary practices, ritual and ideology (Aubet 2006: 94–95). It is likely that colonies proper, unlike

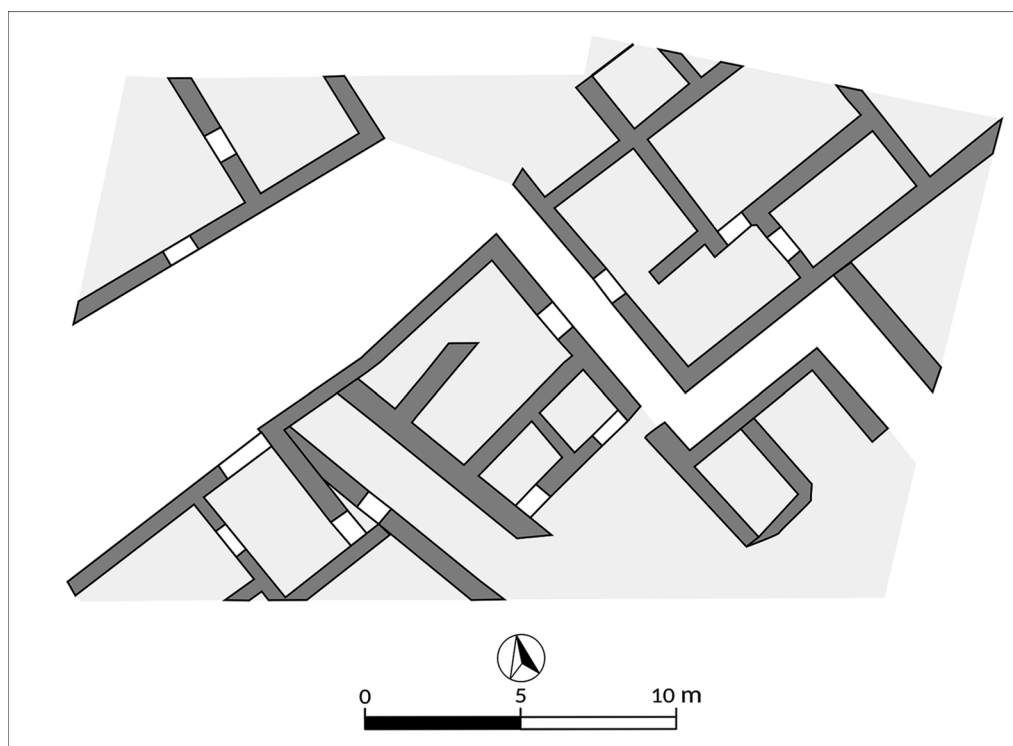

Figure 5. Plan showing the urban character of the 'Teatro Cómico' area at Gadir (Early Iron Age B period) (modified from Gener Ballasote et al. 2014: fig. 25).

Phoenician 'quarters', exerted political control over a territory, including satellite settlements, which gave them access to a wider array of resources. Some colonies were true urban centres, such as Gadir and perhaps Cerro del Villar (Gener Ballasote *et al.* 2014; Aubet 2019). The former had residential areas, with large houses presumably occupied by wealthy merchants (Figure 5). Furthermore, at Gadir, following an initial period in which imported eastern Phoenician wares dominate archaeological assemblages, newly created ceramic workshops began to produce wares in a distinctive western Phoenician style.

Readers will have noticed that quotation marks have been added to the term colony in many instances. That is because post-colonial research has shown that the concept of colony is not straightforward (e.g. van Dommelen 1997; Dietler & López-Ruiz 2009: viii; Marín Aguilera 2012). If taken uncritically, one may think that the 'colonies' mentioned were exclusively a Phoenician project, and that their existence reflects the political supremacy of Tyre over Indigenous groups. The acquiescence of local communities and political agreements between both parties, however, were necessary preconditions for their creation. The 'colony' at Cerro del Villar, for example, could not have survived without a continuous supply of basic agricultural goods from surrounding communities (Aubet 2019: 82). Local people and newcomers surely lived together, or alongside each other, in these 'colonies', as attested by the ceramic assemblages from the earliest deposits at Gadir, which are dominated by Indigenous wares (up to 60–70 per cent) (Torres Ortiz *et al.* 2014: 51). Certainly, 'colonies' served as the

backdrop for the emergence of new social identities and hybrid materialities (Delgado Hervás 2014: 284).

What happened to the Early Iron Age A sites of southern Iberia? The sanctuary at El Carabolo remained in use for an extended period, probably as a Phoenician sanctuary within a broadly local Iron Age context. By contrast, Alcorrín was abandoned before the end of the eighth century, and Ratinhos MN23 was violently destroyed in *c.* 750 BC. Perhaps these sites were no longer necessary, but it is also possible that some local communities rejected the new state of affairs and rebelled against it. In this regard, it is worth noting that the abandonment of the temples at La Rebanadilla in the eighth century BC roughly coincided with the foundation of the nearby Cerro del Villar Phoenician 'colony'. It is currently unclear for how long the Phoenician 'quarter' at Huelva survived, or whether it evolved into something else.

Conclusions

Our synthesis of new evidence shows that, at least in the westernmost Mediterranean, Phoenician 'colonies' of the eighth century BC were preceded, in the ninth century, by a presence of Phoenicians in a range of contexts and sites that were not under their political control. Some were perhaps Phoenician districts associated with Indigenous centres, within which Levantine merchants settled on a permanent basis. Other sites, such as sanctuaries located in peripheral areas or Indigenous settlements where Phoenician craftsmen worked, must have experienced a more sporadic or intermittent Phoenician presence. Taken together, they represent the materialisation of complex processes of interaction and negotiation between Phoenicians, led by Tyre, and southern Iberian communities. Relevant data are still scarce and uncertainties remain, leading to our tentative conclusions, which, we hope, will be tested by future investigations. Such research is not only key for understanding the integration of the Phoenicians into southern Iberia, but is of wider significance for apprehending the mechanisms of colonisation and pre-colonial situations elsewhere in protohistoric Europe and in other contexts around the world (Dietler 2010).

Acknowledgements

We are grateful to the research team investigating the site of Los Castillejos de Alcorrín, coordinated by Dirce Marzoli, Director of the German Archaeological Institute in Madrid. M.E. Aubet supported us and helped us to understand this complex period better. We also thank the two anonymous peer reviewers for their work on this article.

Funding statement

Funding for Open Access charge: Universidad de Málaga/CBUA.

Supplementary material

To view supplementary material for this article, please visit <https://doi.org/10.15184/aqy.2021.105>.

References

- AUBET, M.E. 2006. On the organization of the Phoenician colonial system in Iberia, in C. Riva & N. Vella (ed.) *Debating orientalization: multidisciplinary approaches to change in the ancient Mediterranean* (Monographs in Mediterranean Archaeology 10): 94–109. London: Equinox.
- 2012. El barrio comercial fenicio como estrategia colonial. *Rivista di Studi Fenici* 40: 221–36.
- 2019. Tyre and its colonial expansion, in C. López-Ruiz & B.R. Doak (ed.) *The Oxford handbook of the Phoenician and Punic Mediterranean*: 73–87. Oxford: Oxford University Press.
<https://doi.org/10.1093/oxfordhb/9780190499341.013.6>
- BERROCAL-RANGEL, L. & A.C. SILVA (ed.). 2010. *O castro dos Ratinhos (Barragem do Alqueva, Moura): Escavações num povoado proto-histórico do Guadiana, 2004–2007* (O Arqueólogo Português Suplemento 6). Lisbon: Museu Nacional de Arqueologia.
- BERROCAL-RANGEL, L., A.C. SILVA & F. PRADOS MARTÍNEZ. 2012. El Castro dos Ratinhos: un ejemplo de orientalización entre las jefaturas del Bronce Final del Suroeste, in J. Jiménez Avila (ed.) *Sidereum Ana II: el río Guadiana en el Bronce Final*: 167–83 (Anejos de Archivo Español de Arqueología 62). Mérida: Consejo Superior de Investigaciones Científicas, Junta de Extremadura-Consorcio de Mérida & Instituto de Arqueología-Mérida.
- BRONK RAMSEY, C. 2017. Methods for summarizing radiocarbon datasets. *Radiocarbon* 59: 1809–33.
<https://doi.org/10.1017/RDC.2017.108>
- DELGADO HERVÁS, A. 2008. Fenicios en Iberia, in F. Gracia Alonso (ed.) *De Iberia a Hispania*: 347–474. Barcelona: Ariel.
- 2014. Cultura material, etnicidad y contacto cultural en la arqueología tartésica. Movilidad, contacto y cambio, in E. García Alfonso (ed.) *Movilidad, contacto y cambio. Antequera, 15, 16 y 17 de febrero de 2012. II Congreso de Prehistoria de Andalucía*: 279–91. Seville: Conjunto Arqueológico Dólmenes de Antequera. Consejería de Educación, Cultura y Deporte de la Junta de Andalucía.
- DIETLER, M. 2010. *Archaeologies of colonialism: consumption, entanglement, and violence in ancient Mediterranean France*. Berkeley: University of California Press.
- DIETLER, M. & C. LÓPEZ-RUIZ. 2009. Ex Occidente lux: a preface, in M. Dietler & C. López Ruiz (ed.) *Colonial encounters in ancient Iberia: Phoenician, Greek, and Indigenous relations*: vii–xiii. Chicago (IL): University of Chicago Press.
- VAN DOMMELEN, P. 1997. Colonial constructs: colonialism and archaeology in the Mediterranean. *World Archaeology* 28: 305–23.
<https://doi.org/10.1080/00438243.1997.9980350>
- ESCACENA CARRASCO, J.L. & M.I. VÁZQUEZ BOZA. 2009. Conchas de salvación. *Spal* 18: 53–84.
<https://doi.org/10.12795/spal.2009.i18.04>
- ESCACENA CARRASCO, J.L., Á. FERNÁNDEZ FLORES & A. RODRÍGUEZ AZOGUE. 2007. Sobre el Carambolo: un hippos sagrado del santuario IV y su contexto arqueológico. *Archivo Español de Arqueología* 80: 5–28.
<https://doi.org/10.3989/aespa.2007.v80.25>
- FERNÁNDEZ FLORES, Á. & A. RODRÍGUEZ AZOGUE. 2005. El complejo monumental del Carambolo Alto, Camas (Sevilla): un santuario orientalizante en la paleodesembocadura de Guadalquivir. *Trabajos de Prehistoria* 62: 111–38.
<https://doi.org/10.3989/tp.2005.v62.i1.58>
- 2010. El Carambolo, secuencia cronocultural del yacimiento: síntesis de las intervenciones 2002–2005, in M.L. de la Bandera Romero & E. Ferrer Albelda (ed.) *El Carambolo: 50 años de un tesoro*: 203–70. Seville: Universidad de Sevilla.
- FERNÁNDEZ FLORES, Á., M. CASADO ARIZA & E. PRADOS PÉREZ. 2020. Primeros vestigios de la colonización fenicia en el Carambolo: el edificio inicial (Carambolo V), función y cronología, in J.L. López Castro (ed.) *Entre Útica y Gadir: navegación y colonización fenicia en el mediterráneo occidental a comienzos del I milenio a.C.*: 201–28. Granada: Comares Arqueología.
- GARCÍA ALFONSO, E. 2007. *En la orilla de Tartesos: indígenas y fenicios en las tierras malagueñas, siglos XI–VI a.C.* Málaga: Fundación Málaga.
- 2016. Las primeras importaciones griegas en Occidente y la cronología de la cerámica geométrica: hacia un nuevo paradigma (I). *Menga: Revista de prehistoria de Andalucía* 7: 101–32.
- GARCÍA FERNÁNDEZ, M. et al. 2016. New data about the beginning of the Phoenician colonization in Huelva: archaeological excavation at 3,

- Concepción Street. *Forum Romanum Belgicum* 2016: 13.5.
- GENER BALLASOTE, J.M. *et al.* 2014. Arquitectura y urbanismo de la Gadir fenicia: el yacimiento del 'Teatro Cómico' de Cádiz, in M. Botto (ed.) *Los fenicios en la Bahía de Cádiz: nuevas investigaciones* (Collezione di studi fenici 46): 14–50. Pisa & Rome: Fabrizio Serra.
- GILBOA, A. 2013. À propos Huelva: a reassessment of 'early' Phoenicians in the West, in J.M. Campos Carrasco & J. Alvar Ezquerro (ed.) *Tartessos: el emporio del metal*: 311–42. Córdoba: Almuzara.
- GÓMEZ TOSCANO, F., J.M. BELTRÁN PINZÓN, D. GONZÁLEZ BATANERO & J.C. VERA RODRÍGUEZ. 2014. El Bronce Final en Huelva: una visión preliminar del poblamiento en su ruedo agrícola a partir del registro arqueológico de La Orden-Seminario. *Complutum* 25: 139–58. https://doi.org/10.5209/rev_CMPL.2014.v25.n1.45360
- GONZÁLEZ DE CANALES, F. 2018. The city-emporion of Huelva (10th–6th centuries BC), in É. Gailledrat, R. Plana Mallart & M. Dietler (ed.) *The emporion in the ancient Western Mediterranean: trade and colonial encounters from the Archaic to the Hellenistic period*: 67–78. Montpellier: Presses universitaires de la Méditerranée.
- GONZÁLEZ DE CANALES, F., L. SERRANO PICHARDO & J. LLOMPART GÓMEZ. 2004. *El emporio fenicio precolonial de Huelva* (ca. 900–770 a.C.). Madrid: Biblioteca Nueva.
- GONZÁLEZ DE CANALES, F., L. SERRANO PICHARDO, J. LLOMPART GÓMEZ & J.A. MONTAÑO. 2018. Los fenicios en Huelva: algunas estimaciones y últimos hallazgos, in M. Botto (ed.) *De Huelva a Malaka: los fenicios en Andalucía a la luz de los descubrimientos más recientes* (Collezione di studi fenici 48): 69–105. Rome: CNR.
- GONZÁLEZ DE CANALES, F., A. MONTANO & J. LLOMPART. 2020. The beginning of grape cultivation in the Iberian Peninsula: a reappraisal after the Huelva (south-western Spain) archaeological finds and new radiocarbon datings. *Onoba* 8: 35–42. <https://doi.org/10.33776/onoba.v8i0.3651>.
- GONZÁLEZ WAGNER, C. 2000. Elites, parentesco y dependencia en Tartessos, in J. Alvar, J.M. Casillas, M. del M. Myro & D. Plácido (ed.) *Las edades de la dependencia durante la Antigüedad* (ARYS 9): 321–48. Madrid: Ediciones Clásicas.
- IACONO, F. *et al.* 2021. Establishing the Middle Sea: the Late Bronze Age of Mediterranean Europe (1700–900 BC). *Journal of Archaeological Research*. <https://doi.org/10.1007/s10814-021-09165-1>
- LÓPEZ CASTRO, J.L. 2019. The Iberian Peninsula, in C. López-Ruiz & B.R. Doak (ed.) *The Oxford handbook of the Phoenician and Punic Mediterranean*: 585–601. Oxford: Oxford University Press. <https://doi.org/10.1093/oxfordhb/9780190499341.013.38>
- MARÍN AGUILERA, B. 2012. Del colonialismo y otros demonios: fenicios en el sur peninsular entre los siglos IX y VII/VI a.C. *Complutum* 23: 147–61. https://doi.org/10.5209/rev_CMPL.2012.v23.n2.40881
- MARZOLI, D. *et al.* 2010. Los inicios del urbanismo en las sociedades autóctonas localizadas en el entorno del estrecho de Gibraltar: investigaciones en los Castillejos de Alcorrín y su territorio (Manilva, Málaga). *Menga: Revista de prehistoria de Andalucía* 1: 153–83.
- MARZOLI, D., J. SUÁREZ PADILLA & M. TORRES ORTIZ. 2014. Die Meerenge östlich von Gibraltar am Übergang von der Bronze- zur Eisenzeit (9.–8. Jh. v. Chr.): zum Forschungsstand. *Madriider Mitteilungen* 55: 167–212.
- MARZOLI, D., J. SUÁREZ-PADILLA & C. LEÓN MARTÍN. 2020a. Los Castillejos de Alcorrín (Manilva, Málaga): transformaciones locales e impacto colonial fenicio en el entorno del Estrecho de Gibraltar (siglos IX–VII a.C.). *Actualidad de la investigación arqueológica en España* 1: 305–23.
- MARZOLI, D. *et al.* 2020b. Los Castillejos de Alcorrín (Manilva, Málaga): un asentamiento fortificado autóctono en el contexto de la primera fase de la presencia fenicia en el entorno del Estrecho de Gibraltar (siglos IX–VIII a.C.), in J.L. López Castro (ed.) *Entre Útica y Gadir: navegación y colonización fenicia en el mediterráneo occidental a comienzos del I milenio a.C.*: 269–92. Granada: Comares Arqueología.
- MEDEROS MARTÍN, A. 2006. Fenicios en Huelva, en el siglo X AC, durante el reinado de Hiram I de Tiro. *Spal* 15: 167–88. <https://doi.org/10.12795/spal.2006.i15.08>
- MURILLO-BARROSO, M. *et al.* 2016. The macro-regional scale of silver production in Iberia

- during the first millennium BC in the context of Mediterranean contacts. *Oxford Journal of Archaeology* 35: 75–100. <https://doi.org/10.1111/ojoa.12079>
- NIJBOER, A.J. & J. VAN DER PLICHT. 2006. An interpretation of the radiocarbon determinations of the oldest Indigenous Phoenicia stratum thus far, excavated at Huelva, Tartessos (south-west Spain). *BABESCH: Bulletin Antieke Beschaving* 81: 31–36. <https://doi.org/10.2143/BAB.81.0.2014423>
- NÚÑEZ, F.J. 2018. Una lectura tipológico-secuencial de los materiales cerámicos orientales más antiguos hallados en Huelva, in M. Botto (ed.) *De Huelva a Malaka: los fenicios en Andalucía a la luz de los descubrimientos más recientes* (Collezione di studi fenici 48): 107–82. Rome: CNR.
- PÉREZ-JORDÀ, G., L. PEÑA-CHOCARRO, M. GARCÍA FERNÁNDEZ & J.C. VERA RODRÍGUEZ. 2017. The beginnings of fruit tree cultivation in the Iberian Peninsula: plant remains from the city of Huelva (southern Spain). *Vegetation History and Archaeobotany* 26: 527–38. <https://doi.org/10.1007/s00334-017-0610-6>.
- PRADOS MARTÍNEZ, F. 2010. La arquitectura sagrada: un santuario del siglo IX a.C., in L. Berrocal-Rangel & A.C. Silva (ed.) *O castro dos Ratinhos (Barragem do Alqueva, Moura): escavações num povoado proto-histórico do Guadiana, 2004–2007* (O Arqueólogo Português Suplemento 6): 259–76. Lisbon: Museu Nacional de Arqueologia.
- REIMER, P.J. et al. 2013. IntCal13 and Marine13 radiocarbon age calibration curves 0–50 000 years cal BP. *Radiocarbon* 55: 1869–87. https://doi.org/10.2458/azu_js_rc.55.16947
- RENZI, M., M. BODE & D. MARZOLI. 2016. Ausbeutung von Bergbauressourcen im Umland von Los Castillejos de Alcorrín (Manilva, Málaga) (Ende 9. und 8. Jh. v. Chr.). Ein Vorbericht. *Madrider Mitteilungen* 57: 139–211.
- RUIZ-GÁLVEZ PRIEGO, M. 2013. *Con el fenicio en los talones: los inicios de la Edad del Hierro en la cuenca del Mediterráneo*. Barcelona: Bellaterra.
- SÁNCHEZ SÁNCHEZ-MORENO, V.M. et al. 2011. La desembocadura del Guadalhorce en los siglos IX y VIII a.C. y su relación con el Mediterráneo, in J.C. Domínguez Pérez (ed.) *Gadir y el círculo del estrecho: propuestas de la arqueología desde un enfoque social*: 187–97. Cádiz: Servicio de Publicaciones Universidad de Cádiz.
- 2012. El asentamiento fenicio de La Rebanadilla a finales del siglo IX a.C., in E. García Alfonso (ed.) *Diez años de arqueología fenicia en la provincia de Málaga (2001–2010)*: 87–104. Seville: Junta de Andalucía, Consejería de Cultura y Deporte.
- 2018. La Rebanadilla, santuario litoral fenicio en el sur de la Península Ibérica, in M. Botto (ed.) *De Huelva a Malaka: los fenicios en Andalucía a la luz de los descubrimientos más recientes* (Collezione di studi fenici 48): 305–23. Rome: CNR.
- TORRES ORTIZ, M. et al. 2014. El material cerámico de los contextos fenicios del ‘Teatro Cómico’ de Cádiz: un análisis preliminar, in M. Botto (ed.) *Los fenicios en la Bahía de Cádiz. Nuevas investigaciones* (Collezione di studi fenici 46): 51–82. Pisa & Rome: Fabrizio Serra.